

# Model ITC-3003D

## Deep Water Directional Transducer

Model ITC-3003D

The **Model ITC-3003D** is a piston type transducer offering a narrow 10-degree conical beam pattern. The transducer is capable of 1000-watt power input at resonance and is designed for depth sounder applications or for beacons and transponders requiring narrow beam transmission and reception at any ocean depth.

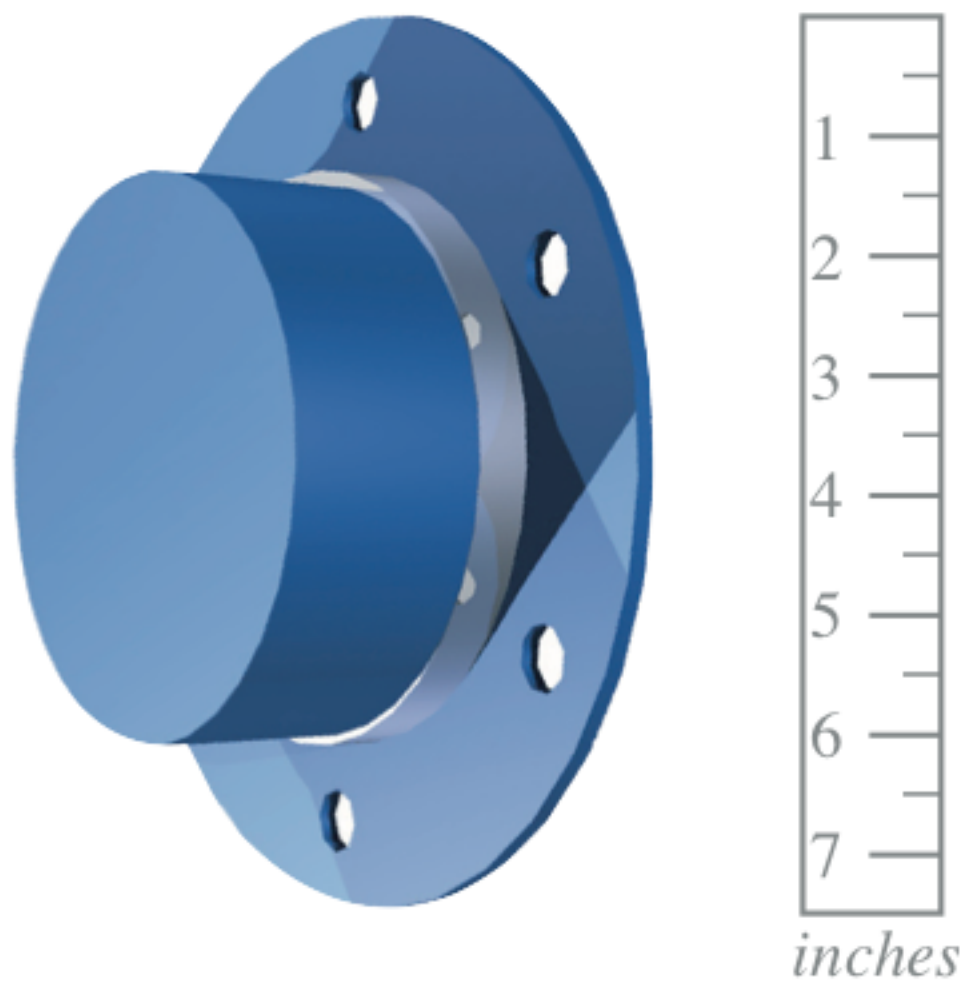

### Specifications (Nominal)

<b>Resonance Frequency <math>f_r</math></b>	118 kHz
<b>Depth</b>	Unlimited
<b>Envelope Dimensions (in.)</b>	2.25D x 7.5H
<b>TVR at <math>f_r</math></b>	160 dB/ $\mu$ Pa/v@1m
<b>Beam Width (-3dB) at <math>f_r</math></b>	10 deg
<b>Beam Type</b>	Conical
<b>Input Power</b>	1000 watts

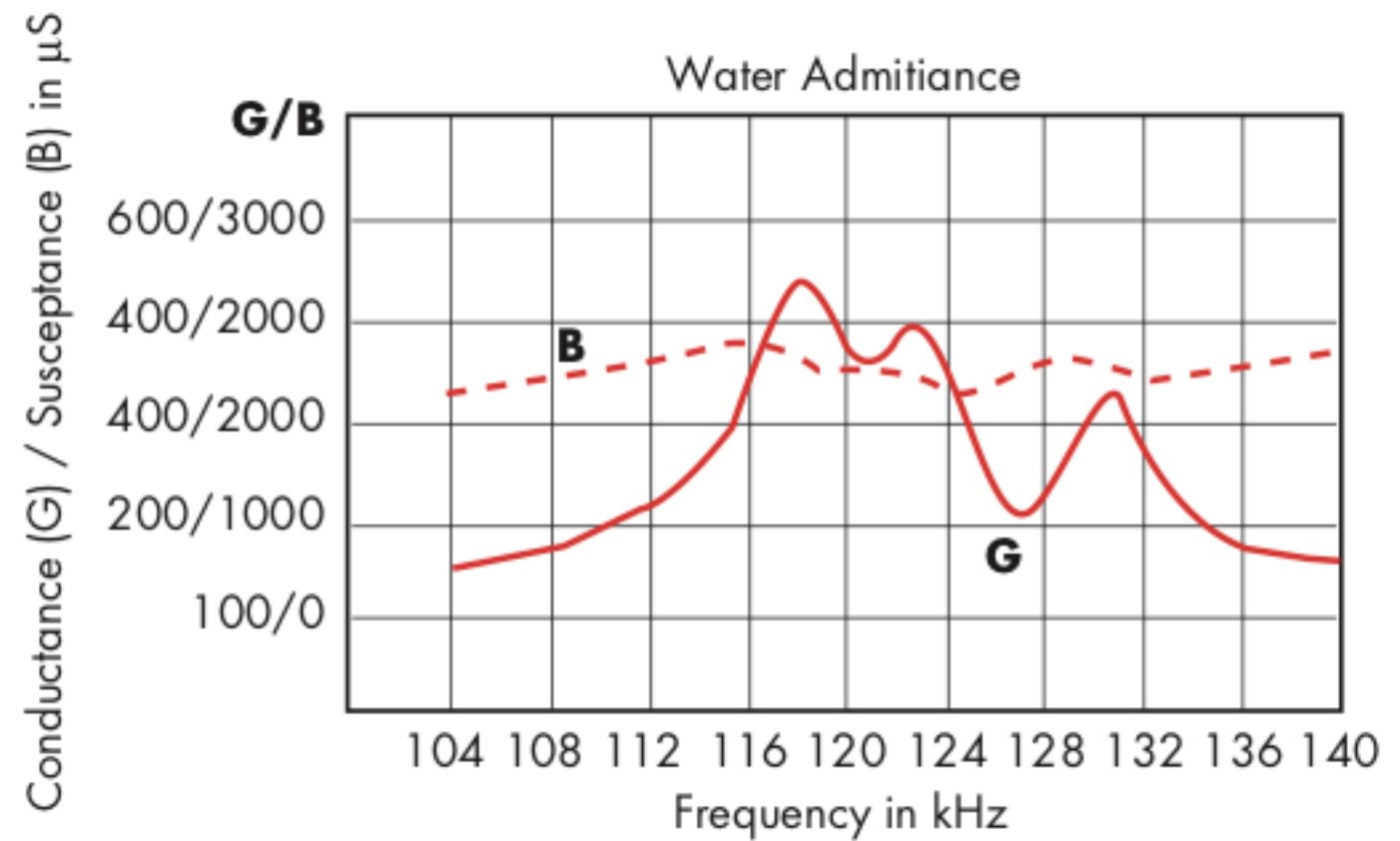
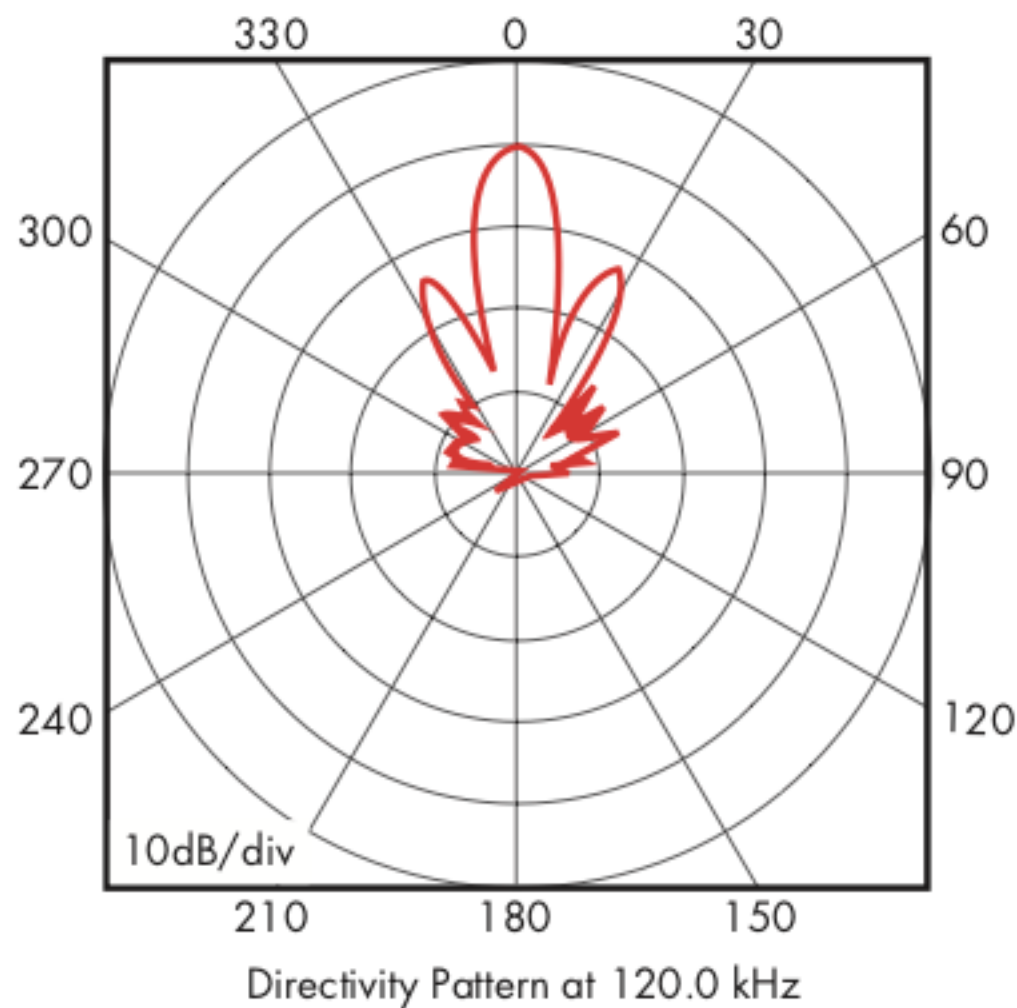
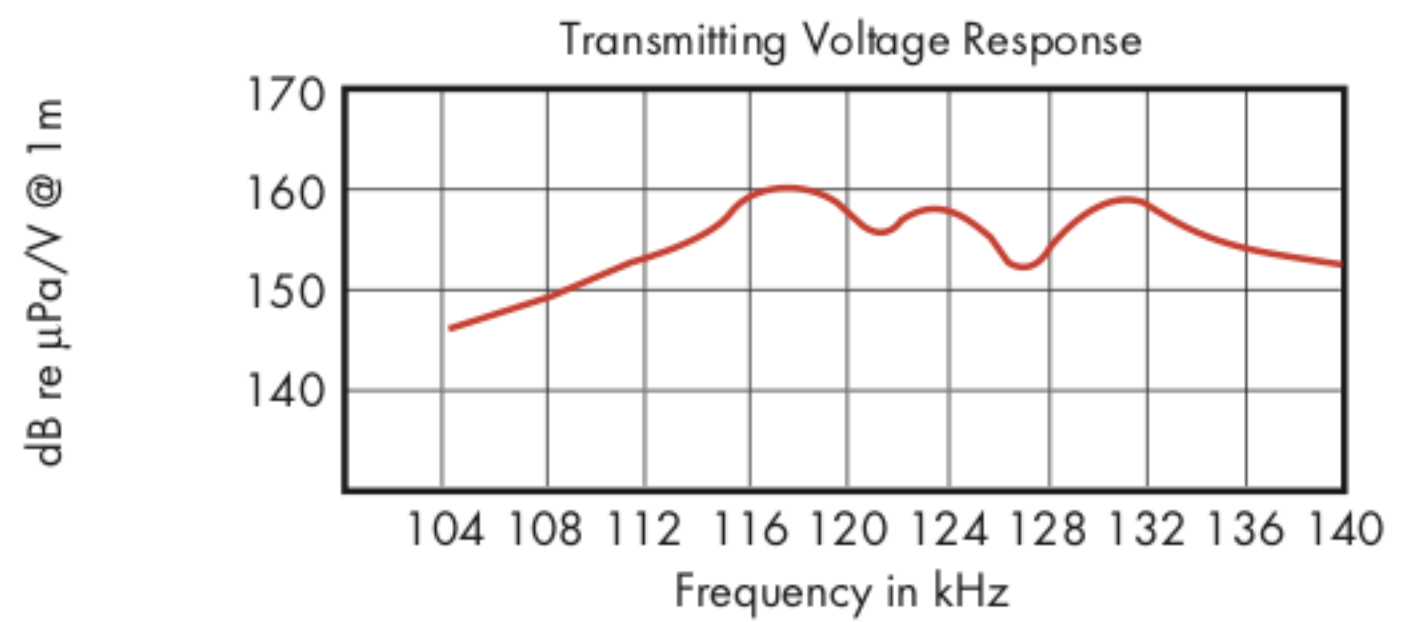
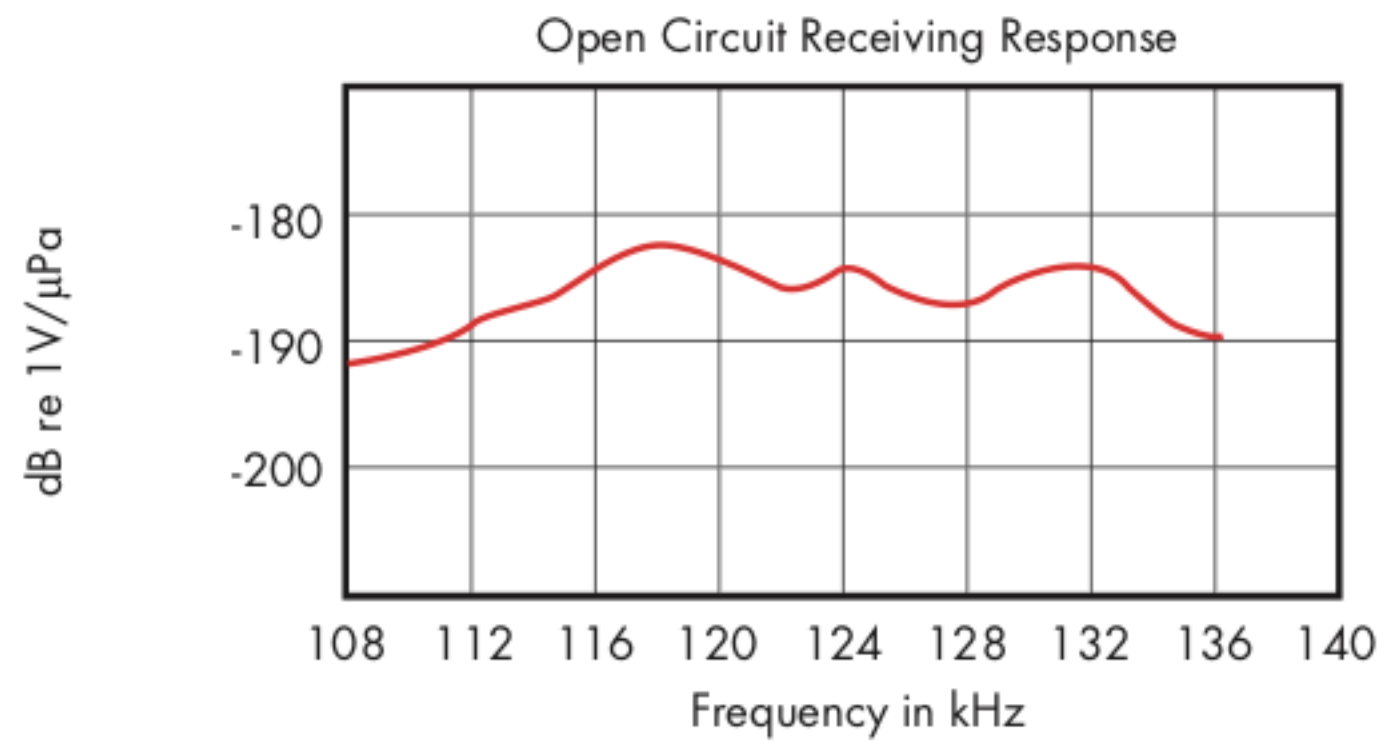

Brent.Febo@Gavial.com  
805-357-2522  
www.GavialITC.com

Gavial ITC  
869 Ward Drive  
Santa Barbara, CA 93111